

© Copyright SEK Svensk Elstandard. Reproduction in any form without permission is prohibited.

Elektrisk utrustning för mätning, styrning och för laboratorieändamål – Säkerhet –

Del 2-032: Särskilda fordringar på strömtänger och tångamperemetrar

*Safety requirements for electrical equipment for measurement, control and laboratory use –
Part 2-032: Particular requirements for hand-held and hand-manipulated current sensors for
electrical test and measurement*

Som svensk standard gäller europastandarden EN IEC 61010-2-032:2021. Den svenska standarden innehåller de officiella engelska språkversionerna av EN IEC 61010-2-032:2021 och EN IEC 61010-2-032:2021/A11:2021.

Nationellt förord

Europastandarden EN IEC 61010-2-032:2021

består av:

- **europastandardens ikraftsättningsdokument**, utarbetat inom CENELEC
- **IEC 61010-2-032, Fourth edition, 2019^{*)} - Safety requirements for electrical equipment for measurement, control and laboratory use - Part 2-032: Particular requirements for hand-held and hand-manipulated current sensors for electrical test and measurement**

utarbetad inom International Electrotechnical Commission, IEC.

Standarden ska användas tillsammans med SS-EN 61010-1, utgåva 3, 2010 och dess separat utgivna tillägg.

Tidigare fastställd svensk standard SS-EN 61010-2-032, utgåva 3, 2013, gäller ej fr o m 2024-11-12.

^{*)} Corrigendum, No 1, February 2020 till IEC 61010-2-032:2019 är inarbetat i standarden.

Standarder underlättar utvecklingen och höjer elsäkerheten

Det finns många fördelar med att ha gemensamma tekniska regler för bl a mätning, säkerhet och provning och för utförande, skötsel och dokumentation av elprodukter och elanläggningar.

Genom att utforma sådana standarder blir säkerhetsfordringar tydliga och utvecklingskostnaderna rimliga samtidigt som marknadens acceptans för produkten eller tjänsten ökar.

Många standarder inom elområdet beskriver tekniska lösningar och metoder som åstadkommer den elsäkerhet som föreskrivs av svenska myndigheter och av EU.

SEK är Sveriges röst i standardiseringsarbetet inom elområdet

SEK Svensk Elstandard svarar för standardiseringen inom elområdet i Sverige och samordnar svensk medverkan i internationell och europeisk standardisering. SEK är en ideell organisation med frivilligt deltagande från svenska myndigheter, företag och organisationer som vill medverka till och påverka utformningen av tekniska regler inom elektrotekniken.

SEK samordnar svenska intressenters medverkan i SEKs tekniska kommittéer och stödjer svenska experters medverkan i internationella och europeiska projekt.

Stora delar av arbetet sker internationellt

Utformningen av standarder sker i allt väsentligt i internationellt och europeiskt samarbete. SEK är svensk nationalkommitté av International Electrotechnical Commission (IEC) och Comité Européen de Normalisation Electrotechnique (CENELEC).

Standardiseringsarbetet inom SEK är organiserat i referensgrupper bestående av ett antal tekniska kommittéer som speglar hur arbetet inom IEC och CENELEC är organiserat.

Arbetet i de tekniska kommittéerna är öppet för alla svenska organisationer, företag, institutioner, myndigheter och statliga verk. Den årliga avgiften för deltagandet och intäkter från försäljning finansierar SEKs standardiseringsverksamhet och medlemsavgift till IEC och CENELEC.

Var med och påverka!

Den som deltar i SEKs tekniska kommittéarbete har möjlighet att påverka framtida standarder och får tidig tillgång till information och dokumentation om utvecklingen inom sitt teknikområde. Arbetet och kontakterna med kollegor, kunder och konkurrenter kan gynnsamt påverka enskilda företags affärsutveckling och bidrar till deltagarnas egen kompetensutveckling.

Du som vill dra nytta av dessa möjligheter är välkommen att kontakta SEKs kansli för mer information.

SEK Svensk Elstandard

Box 1284
164 29 Kista
Tel 08-444 14 00
www.elstandard.se

English Version

**Safety requirements for electrical equipment for measurement,
control and laboratory use - Part 2-032: Particular requirements
for hand-held and hand-manipulated current sensors for
electrical test and measurement
(IEC 61010-2-032:2019 + COR1:2020)**

Exigences de sécurité pour appareils électriques de
mesurage, de régulation et de laboratoire - Partie 2-032 :
Exigences particulières pour les capteurs de courant,
portatifs et manipulés manuellement, pour essai électrique
et mesurage
(IEC 61010-2-032:2019 + COR1:2020)

Sicherheitsbestimmungen für elektrische Mess-, Steuer-,
Regel- und Laborgeräte - Teil 2-032: Besondere
Anforderungen für handgehaltene und handbediente
Stromsonden für elektrische Prüfungen und Messungen
(IEC 61010-2-032:2019 + COR1:2020)

This European Standard was approved by CENELEC on 2019-07-26. CENELEC members are bound to comply with the CEN/CENELEC Internal Regulations which stipulate the conditions for giving this European Standard the status of a national standard without any alteration.

Up-to-date lists and bibliographical references concerning such national standards may be obtained on application to the CEN-CENELEC Management Centre or to any CENELEC member.

This European Standard exists in three official versions (English, French, German). A version in any other language made by translation under the responsibility of a CENELEC member into its own language and notified to the CEN-CENELEC Management Centre has the same status as the official versions.

CENELEC members are the national electrotechnical committees of Austria, Belgium, Bulgaria, Croatia, Cyprus, the Czech Republic, Denmark, Estonia, Finland, France, Germany, Greece, Hungary, Iceland, Ireland, Italy, Latvia, Lithuania, Luxembourg, Malta, the Netherlands, Norway, Poland, Portugal, Republic of North Macedonia, Romania, Serbia, Slovakia, Slovenia, Spain, Sweden, Switzerland, Turkey and the United Kingdom.



European Committee for Electrotechnical Standardization
Comité Européen de Normalisation Electrotechnique
Europäisches Komitee für Elektrotechnische Normung

CEN-CENELEC Management Centre: Rue de la Science 23, B-1040 Brussels

European foreword

The text of document 66/691/FDIS, future edition 4 of IEC 61010-2-032, prepared by IEC/TC 66 "Safety of measuring, control and laboratory equipment" was submitted to the IEC-CENELEC parallel vote and approved by CENELEC as EN IEC 61010-2-032:2021.

The following dates are fixed:

- latest date by which the document has to be implemented at national level by publication of an identical national standard or by endorsement (dop) 2022-05-12
- latest date by which the national standards conflicting with the document have to be withdrawn (dow) 2024-11-12

This document supersedes EN 61010-2-032:2012 and all of its amendments and corrigenda (if any).

Attention is drawn to the possibility that some of the elements of this document may be the subject of patent rights. CENELEC shall not be held responsible for identifying any or all such patent rights.

This document has been prepared under a Standardization Request given to CENELEC by the European Commission and the European Free Trade Association, and supports essential requirements of EU Directive(s) / Regulation(s).

For the relationship with EU Directive(s) / Regulation(s), see informative Annex ZZ, which is an integral part of EN IEC 61010-2-032:2021/A11:2021.

Any feedback and questions on this document should be directed to the users' national committee. A complete listing of these bodies can be found on the CENELEC website.

Endorsement notice

The text of the International Standard IEC 61010-2-032:2019 was approved by CENELEC as a European Standard without any modification.

In the official version, for Bibliography, the following notes have to be added for the standards indicated:

IEC 61010-2-033	NOTE	Harmonized as EN IEC 61010-2-033
IEC 61010-2-034	NOTE	Harmonized as EN IEC 61010-2-034
IEC 61557-1	NOTE	Harmonized as EN 61557-1
IEC 61557-2	NOTE	Harmonized as EN 61557-2
IEC 61557-3	NOTE	Harmonized as EN 61557-3
IEC 61557-4	NOTE	Harmonized as EN 61557-4
IEC 61557-5	NOTE	Harmonized as EN 61557-5
IEC 61557-6	NOTE	Harmonized as EN 61557-6
IEC 61557-7	NOTE	Harmonized as EN 61557-7

IEC 61557-8	NOTE	Harmonized as EN 61557-8
IEC 61557-9	NOTE	Harmonized as EN 61557-9
IEC 61557-10	NOTE	Harmonized as EN 61557-10
IEC 61557-11	NOTE	Harmonized as EN 61557-11
IEC 61557-12	NOTE	Harmonized as EN 61557-12

INTERNATIONAL STANDARD

NORME INTERNATIONALE



**Safety requirements for electrical equipment for measurement, control
and laboratory use –
Part 2-032: Particular requirements for HAND-HELD and hand-manipulated
current sensors for electrical test and measurement**

**Exigences de sécurité pour appareils électriques de mesurage, de régulation
et de laboratoire –
Partie 2-032: Exigences particulières pour les capteurs de courant, PORTATIFS
et manipulés manuellement, pour essai électrique et mesurage**

INTERNATIONAL
ELECTROTECHNICAL
COMMISSION

COMMISSION
ELECTROTECHNIQUE
INTERNATIONALE

ICS 19.080

ISBN 978-2-8322-6994-7

**Warning! Make sure that you obtained this publication from an authorized distributor.
Attention! Veuillez vous assurer que vous avez obtenu cette publication via un distributeur agréé.**

CONTENTS

FOREWORD.....	4
INTRODUCTION.....	7
1 Scope and object.....	8
2 Normative references	10
3 Terms and definitions	10
4 Tests	11
5 Marking and documentation.....	12
6 Protection against electric shock	16
7 Protection against mechanical HAZARDS.....	21
8 Resistance to mechanical stresses	21
9 Protection against the spread of fire	25
10 Equipment temperature limits and resistance to heat.....	25
11 Protection against HAZARDS from fluids and solid foreign objects	26
12 Protection against radiation, including laser sources, and against sonic and ultrasonic pressure	26
13 Protection against liberated gases and substances, explosion and implosion	26
14 Components and subassemblies	27
15 Protection by interlocks	28
16 HAZARDS resulting from application	28
17 RISK assessment	28
Annexes	36
Annex D (normative) Parts between which insulation requirements are specified (see 6.4, 6.5.3, 6.9.101 and 6.101).....	36
Annex F (normative) Routine tests	38
Annex K (normative) Insulation requirements not covered by 6.7	39
Annex L (informative) Index of defined terms	46
Annex AA (normative) MEASUREMENT CATEGORIES	47
Annex BB (informative) HAZARDS pertaining to measurements performed in certain environments	49
Annex CC (informative) 4-mm "banana" TERMINALS	52
Annex DD (informative) Flowchart for insulation according to the type of circuit.....	54
Annex EE (normative) CLAMP MULTIMETER	57
Bibliography.....	60
Figure 101 – Examples of current sensors and their parts.....	9
Figure 102 – CLEARANCE between the PROTECTIVE BARRIER to the JAWS and to the HAZARDOUS LIVE conductor	19
Figure 103 – Abrasion test of the JAW ENDS.....	22
Figure 104 – Impact points for JAW impact test.....	23
Figure 105 – Indentation device	24
Figure 106 – Test probe to check protection against short-circuits	34
Figure 107 – Use of the test probe of Figure 106	34

Figure D.101 – Parts of current sensors (see also Table D.101)	36
Figure AA.1 – Example to identify the locations of measuring circuits	48
Figure CC.1 – Recommended dimensions of 4-mm TERMINALS	53
Figure DD.1 – Requirements for CLEARANCE, CREEPAGE DISTANCE and solid insulation.....	56
Figure EE.1 – Examples of CLAMP MULTIMETERS	57
Table 1 – Symbols	12
Table 101 – CLEARANCES and CREEPAGE DISTANCES for measuring circuit TERMINALS with HAZARDOUS LIVE conductive parts up to 1 000 V a.c. or 1 500 V d.c.....	17
Table 102 – Energy level for JAW impact test	22
Table 103 – Pull forces for endcaps of flexible current sensors	25
Table 104 – Impulse voltages	28
Table 105 – Thickness of the test probe of Figure 106 and test voltages.....	35
Table D.101 – Insulation requirements for current sensors.....	37
Table K.101 – CLEARANCES of measuring circuits RATED for MEASUREMENT CATEGORIES	40
Table K.102 – a.c. test voltages for testing electric strength of solid insulation in measuring circuits RATED for MEASUREMENT CATEGORIES	41
Table K.103 – Impulse test voltages for testing electric strength of solid insulation in measuring circuits RATED for MEASUREMENT CATEGORIES	42
Table K.104 –Test voltages for testing long-term stress of solid insulation in measuring circuits RATED for MEASUREMENT CATEGORIES	43
Table K.105 – Minimum values for distance or thickness of solid insulation in measuring circuits RATED FOR MEASUREMENT CATEGORIES III and IV	44
Table AA.1 – Characteristics of MEASUREMENT CATEGORIES	48

INTERNATIONAL ELECTROTECHNICAL COMMISSION

SAFETY REQUIREMENTS FOR ELECTRICAL EQUIPMENT FOR MEASUREMENT, CONTROL, AND LABORATORY USE –

Part 2-032: Particular requirements for HAND-HELD and hand-manipulated current sensors for electrical test and measurement

FOREWORD

- 1) The International Electrotechnical Commission (IEC) is a worldwide organization for standardization comprising all national electrotechnical committees (IEC National Committees). The object of IEC is to promote international co-operation on all questions concerning standardization in the electrical and electronic fields. To this end and in addition to other activities, IEC publishes International Standards, Technical Specifications, Technical Reports, Publicly Available Specifications (PAS) and Guides (hereafter referred to as "IEC Publication(s)"). Their preparation is entrusted to technical committees; any IEC National Committee interested in the subject dealt with may participate in this preparatory work. International, governmental and non-governmental organizations liaising with the IEC also participate in this preparation. IEC collaborates closely with the International Organization for Standardization (ISO) in accordance with conditions determined by agreement between the two organizations.
- 2) The formal decisions or agreements of IEC on technical matters express, as nearly as possible, an international consensus of opinion on the relevant subjects since each technical committee has representation from all interested IEC National Committees.
- 3) IEC Publications have the form of recommendations for international use and are accepted by IEC National Committees in that sense. While all reasonable efforts are made to ensure that the technical content of IEC Publications is accurate, IEC cannot be held responsible for the way in which they are used or for any misinterpretation by any end user.
- 4) In order to promote international uniformity, IEC National Committees undertake to apply IEC Publications transparently to the maximum extent possible in their national and regional publications. Any divergence between any IEC Publication and the corresponding national or regional publication shall be clearly indicated in the latter.
- 5) IEC itself does not provide any attestation of conformity. Independent certification bodies provide conformity assessment services and, in some areas, access to IEC marks of conformity. IEC is not responsible for any services carried out by independent certification bodies.
- 6) All users should ensure that they have the latest edition of this publication.
- 7) No liability shall attach to IEC or its directors, employees, servants or agents including individual experts and members of its technical committees and IEC National Committees for any personal injury, property damage or other damage of any nature whatsoever, whether direct or indirect, or for costs (including legal fees) and expenses arising out of the publication, use of, or reliance upon, this IEC Publication or any other IEC Publications.
- 8) Attention is drawn to the Normative references cited in this publication. Use of the referenced publications is indispensable for the correct application of this publication.
- 9) Attention is drawn to the possibility that some of the elements of this IEC Publication may be the subject of patent rights. IEC shall not be held responsible for identifying any or all such patent rights.

International Standard IEC 61010-2-032 has been prepared by IEC technical committee 66: Safety of measuring, control and laboratory equipment.

This fourth edition cancels and replaces the third edition published in 2012. This edition constitutes a technical revision.

This edition includes the following significant technical changes with respect to the previous edition:

- a) It has been indicated that current sensors used as FIXED EQUIPMENT are not within the scope of this document.
- b) Fork-style current sensors have been added.

- c) Requirements from Part 2-033 applicable to CLAMP MULTIMETERS that have a primary purpose of measuring voltage on live MAINS have been included in the new normative Annex EE.
- d) CLEARANCES and CREEPAGE DISTANCES for measuring circuit TERMINALS exceeding 1 000 V a.c. or 1 414 V d.c. and for WET LOCATIONS have been specified.
- e) Reduced CREEPAGE DISTANCES are allowed to be according to material group I for all insulating materials.
- f) Requirements for input/output circuits of Type A, Type B and Type C current sensors have been detailed in 6.9.102.
- g) Requirements for output circuit leads have been modified.
- h) The JAW impact test has been limited to the front of the JAWS.
- i) The abrasion test for cords of flexible current sensors has been removed and replaced by a pressure test at high temperature.
- j) The voltage source for testing overvoltage limiting components or circuits may be limited to 400 V.
- k) Reference to IEC 61010-031 for probe assemblies has been added.
- l) Requirements for the prevention of TRANSIENT OVERVOLTAGES for MAINS voltage measuring circuits have been added.
- m) Requirements for measuring circuits from 1 000 V to 3 000 V have been added.
- n) An informative Annex CC about the dimensions of banana TERMINALS has been added.
- o) A flowchart for insulation according to the type of circuit has been added in a new Annex DD.

The text of this International Standard is based on the following documents:

FDIS	Report on voting
66/691/FDIS	66/695/RVD

Full information on the voting for the approval of this International Standard can be found in the report on voting indicated in the above table.

This document has been drafted in accordance with the ISO/IEC Directives, Part 2.

A list of all parts of the IEC 61010 series, under the general title *Safety requirements for electrical equipment for measurement, control, and laboratory use*, can be found on the IEC website.

This Part 2-032 is to be used in conjunction with the latest edition of IEC 61010-1. It was established on the basis of the third edition (2010) of IEC 61010-1 and its Amendment 1 (2016), hereinafter referred to as Part 1.

This Part 2-032 supplements or modifies the corresponding clauses in IEC 61010-1 so as to convert that publication into the IEC standard: *Particular requirements for HAND-HELD and hand-manipulated current sensors for electrical test and measurement*.

Where a particular subclause of Part 1 is not mentioned in this Part 2-032, that subclause applies as far as is reasonable. Where this Part 2-032 states "addition", "modification", "replacement", or "deletion" the relevant requirement, test specification or note in Part 1 should be adapted accordingly.

In this standard:

- a) the following print types are used:
- requirements: in roman type;
 - NOTES: in small roman type;
 - *conformity and tests: in italic type;*
 - terms used throughout this standard which have been defined in Clause 3: SMALL ROMAN CAPITALS;
- b) subclauses, figures, tables and notes which are additional to those in Part 1 are numbered starting from 101. Additional annexes are lettered starting from AA and additional list items are lettered from aa).

The committee has decided that the contents of this document will remain unchanged until the stability date indicated on the IEC website under "<http://webstore.iec.ch>" in the data related to the specific document. At this date, the document will be

- reconfirmed,
- withdrawn,
- replaced by a revised edition, or
- amended.

IMPORTANT – The 'colour inside' logo on the cover page of this publication indicates that it contains colours which are considered to be useful for the correct understanding of its contents. Users should therefore print this document using a colour printer.

The contents of the corrigendum of February 2020 have been included in this copy.

INTRODUCTION

Part 2-030 specifies the safety requirements for equipment with testing and measuring circuits which are connected for test or measurement purposes to devices or circuits outside the measurement equipment itself. Requirements of Part 2-030 have been included in this Part 2-032. Equipment within the scopes of both Part 2-030 and Part 2-032 are considered to be covered by the requirements of this Part 2-032.

Part 2-033 specifies the safety requirements for hand-held multimeters that have the primary purpose of measuring voltage on live MAINS. For equipment within the scope of Part 2-032 and Part 2-033, only this Part 2-032 is applicable.

Part 2-034 specifies the safety requirements for measurement equipment for insulation resistance and test equipment for electric strength which are connected to units, lines or circuits for test or measurement purposes. For equipment within the scope of Part 2-032 and Part 2-034, both documents should be read in conjunction.

SAFETY REQUIREMENTS FOR ELECTRICAL EQUIPMENT FOR MEASUREMENT, CONTROL, AND LABORATORY USE –

Part 2-032: Particular requirements for HAND-HELD and hand-manipulated current sensors for electrical test and measurement

1 Scope and object

This clause of Part 1 is applicable except as follows:

1.1.1 Equipment included in scope

Replace the existing text with the following:

This part of IEC 61010 specifies safety requirements for HAND-HELD and hand-manipulated current sensors described below.

These current sensors are for measuring, detecting or injecting current, or indicating current waveforms on circuits without physically opening the current path of the circuit being measured. They can be stand-alone current sensors or accessories to other equipment or parts of combined equipment (see Figure 101). These include measurement circuits which are part of electrical test and measurement equipment, laboratory equipment, or process control equipment. These current sensors and circuits need additional protective means between the current sensor, the circuit and an OPERATOR.

NOTE 1 Combined equipment is equipment that is electrically connected to a current sensor by means of a permanent connection which can be detached only by the use of a TOOL.

NOTE 2 Some current sensors are also known as current clamps, CLAMP MULTIMETERS and current probes.

Current sensors are hand-manipulated before and/or after a test or measurement, but do not necessarily need to be HAND-HELD during the test or measurement. Current sensors used as FIXED EQUIPMENT are not within the scope of this document.

The following types of current sensors are covered:

- a) Type A: a current sensor designed to be applied to or removed from HAZARDOUS LIVE UNINSULATED CONDUCTORS. Type A current sensors have defined HAND-HELD or hand-manipulated parts providing protection against electric shock from the conductor being measured, and also have protection against short-circuits between wires and between busbars during clamping.
- b) Type B: a current sensor which has protection against short-circuits between wires or busbars during clamping but without defined HAND-HELD or hand-manipulated parts which provide protection against electric shock during clamping. Additional protective means are necessary to avoid electric shock from HAZARDOUS LIVE conductors which cannot be de-energised during application or removal of the current sensor.

EXAMPLE 1 Flexible current sensors.

- c) Type C: a current sensor without protection against short-circuits between wires or busbars during clamping. Type C current sensors are intended to be applied to or removed from HAZARDOUS LIVE UNINSULATED CONDUCTORS or from non-limited-energy circuit conductors only when they are de-energised.

EXAMPLE 2 Split-core transducers.

- d) Type D: a current sensor designed to be applied to or removed from insulated conductors or from limited-energy circuit conductors.

EXAMPLE 3 Current probes for oscilloscopes and earth leakage current detectors.

All current sensors can also be used with insulated conductors. In this case, HAZARDS are limited to acceptable levels by the insulation of the conductors.

Additional requirements for CLAMP MULTIMETERS are given in Annex EE.

Figure 101 shows graphical representations of typical current sensors for illustration purposes. Current sensors can look different depending on the design.

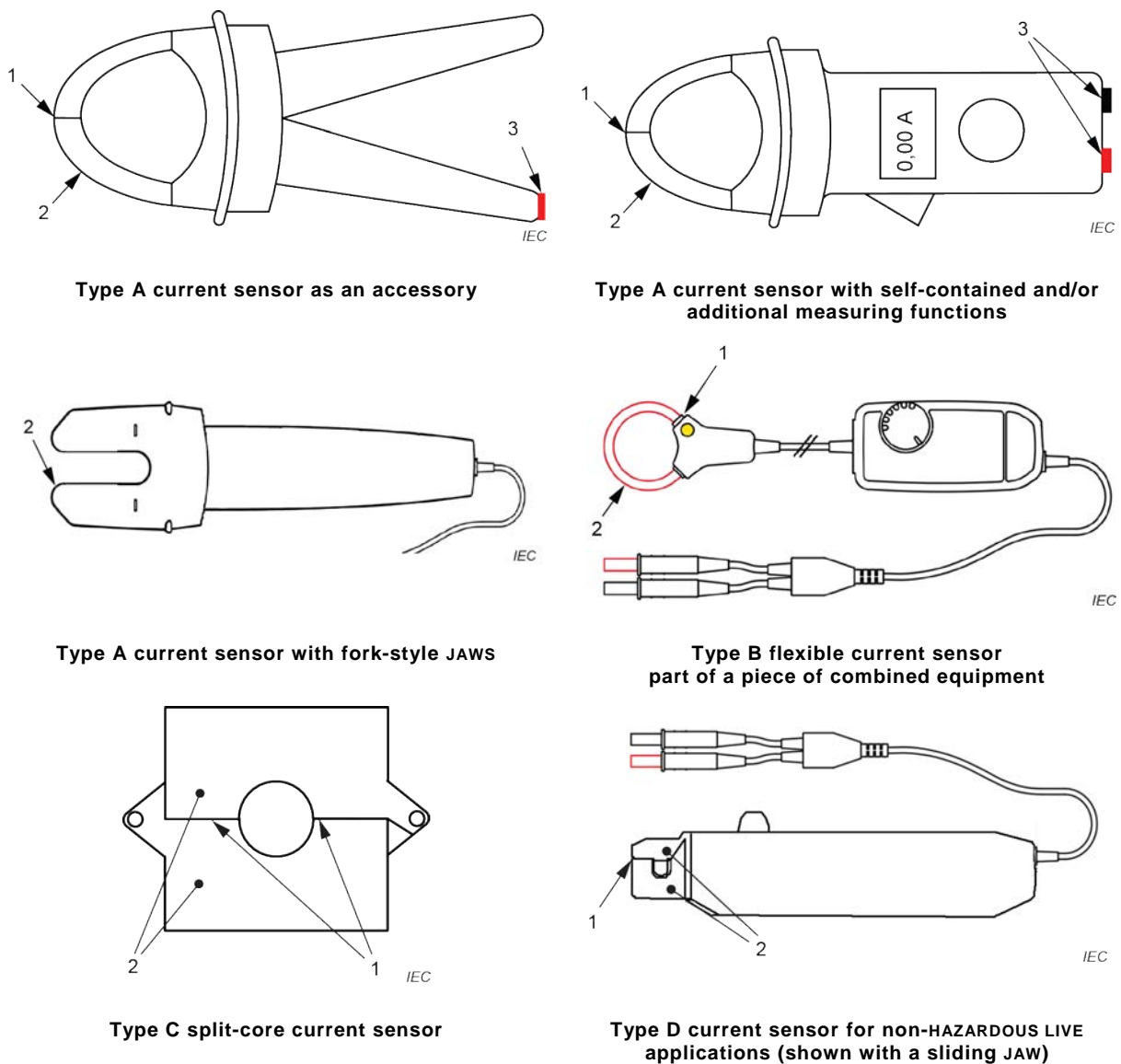

Key

- 1 JAW END(S)
- 2 JAW
- 3 Measuring circuit TERMINALS

Figure 101 – Examples of current sensors and their parts

1.2.1 Aspects included in scope

Add the following three new paragraphs at the end of the subclause:

Requirements for protection against HAZARDS resulting from NORMAL USE and REASONABLY FORESEEABLE MISUSE of measuring circuits are given in Clause 101.

Requirements for prevention of HAZARD from arc flash and short-circuits are given in Clause 102.

Requirements for reliance on the displayed value of CLAMP MULTIMETERS are given in Clause EE.5 .

2 Normative references

This clause of Part 1 is applicable except as follows:

Replace "IEC 61010-031" with the following new reference:

IEC 61010-031:2015, *Safety requirements for electrical equipment for measurement, control and laboratory use – Part 031: Safety requirements for hand-held and hand-manipulated probe assemblies for electrical test and measurement*
IEC 61010-031:2015/AMD1:2018

Replace "IEC 61180-1 (all parts)", "IEC 61180-1" and "IEC 61180-2", with the following new reference:

IEC 61180, *High-voltage test techniques for low-voltage equipment – Definitions, test and procedure requirements, test equipment*